

"Community & Business Training, Economic Development, Partnerships,
Job Creation.....Rural American Indian Communities Moving Forward"



Operated by Southwest Business Development Consultants, LLC Funded by MBDA-U.S. Department of Commerce

FWD Client Success Story

3rd Quarter 2019-2020

Indigenous Design Studio + Architecture

8008 Pennsylvania Circle NE
Albuquerque, New Mexico 87110

Web: www.ids-a.com

P: (505) 226-2565

E: marketing@ids-a.com

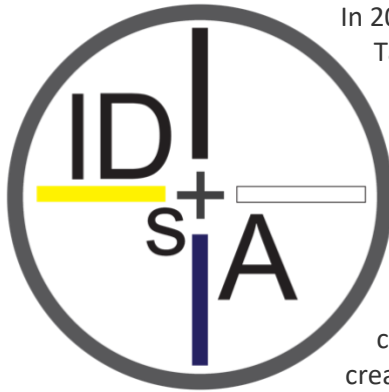

In 2012, Indigenous Design Studio + Architecture (IDS+A) was established by Tamarah Begay as the first Navajo woman-owned architectural firm in Albuquerque, New Mexico. The firm was started with an interest and a desire to focus within Native American and Indigenous communities throughout the country and was created to provide culturally unique, sustainable and innovative designs for Native American Tribes and Indigenous communities, where they can be stimulated by the experience of the designs that encompass their natural surroundings while preserving their history and culture. IDS+A finds that working corroboratively with clients brings a unique assimilation of ideas and creativity. Each community's individual identity drives each project's plan, physical form, and contextual response to their environment. Since then, IDS+A has expanded its footprint to encompass a number of successful projects throughout numerous communities.

Tamarah is the Founder of IDS+A, a Native American Woman-Owned architectural firm. Ms. Begay is a member of the Navajo Nation and has over 15 years of experience working with Native American tribes on public safety, judicial, educational, housing projects, gaming and her recent work for the Navajo Nation has focused on feasibility studies and master planning. She brings her broad expertise in cultural sensitivity to strengthen the design of projects with Native American tribes.

Tamarah is a high-level LEED (Leadership in Energy and Environmental Design) Accredited Professional experienced in incorporating current sustainable practices into her innovative planning and design work. As a founding member of the American Indian Council of Architects and Engineers, Tamarah has long been committed to mentoring junior Native American office staff and students. Ms. Begay is an exceptionally talented visionary, uniquely driven to instill Native American cultural identity in all work that IDS+A designs.





Operated by Southwest Business Development Consultants, LLC Funded by MBDA-U.S. Department of Commerce

Quality

Advocating for the client by delivering service that is honest and fair, and providing design that is sensitive to culture and the environment.

Cost Conscious

Our responsibility and priority are to deliver our best work yet remain aware and vigilant of cost considerations.

Sustainability

Creating places for today while looking to the future by learning from the past.

Commitment to Native American Communities

It's not about designing communities, it's about working with the communities.



IDS+A specializes in community-based design and an architectural approach that promotes "participatory design". Our process capabilities throughout the design process includes strategic meetings and hands-on design workshops (charrettes) with all community stakeholders, to incorporate their vision and concerns into the designs. To emphasize the need for effective communication and community facilitation, our Team employs an iterative "participatory design" approach, meeting several times with all of the constituents and communities that we will be planning for, to ensure that their voices, culture and issues are incorporated into our work.

Architecture / Design

- Architecture
- Site Analysis
- Design / Build
- Record Drawings
- Cultural Consulting
- Sustainable / Healthcare
- LEED / Interior Design
- Project Management
- Construction Administration
- Navajo Design & Planning
- Building Information Model
- 3D Modeling & Sketching

Planning

- Master Planning
- Land Use Planning
- Programming
- Feasibility Studies
- Facility Assessments
- Existing Building Renovations

Training & Facilitation

- Economic Development
- Community Participatory Design & Facilitation

Certifications:

Registered Architect (RA) – NM, AZ, UT, CO, NV, OK
LEED AP BD+C – ID# 10400450
Navajo Nation SB Act Certification # 0419-8695 - Priority 1
Certified Construction Document Technologist - 2007

NAICS:

541310 – Architectural Services
541340 – Drafting Services
541410 – Interior Design Services



Indigenous Design Studio + Architecture – Our Work

Navajo Technical University, Chinle Campus Master Plan

Indigenous Design Studio + Architecture (IDS+A) was selected by Navajo Technical University (NTU) to provide Master planning services for the new Chinle Campus. The 38-acre Chinle Campus is at the heart of the Navajo Nation and is projected to become the main campus for the University and support the efforts for NTU to expand its capacity in serving the present and future students.

IDS+A worked closely with the NTU task force to develop the master plan and establish a strategy for the development of the campus. This process began with gathering information about the site, investigating the existing utility infrastructure, information from the owner on needs for the campus and future development. Site access and circulation was studied, and a direction chosen.

The Master Development Plan is the representation of NTU's vision to develop a new educational and residential environment for faculty and students.

Educational, Administrative, Social Spaces, Housing, Outdoor, and Support spaces will be strategically woven into the fabric of the campus resulting in an ultimate buildout plan for the campus. Design Guidelines were developed to direct future development and to establish components such as building materials and landscape for the outdoor features of the Campus. Above all, campus planning will show how the campus can grow from the first building into the future overall development of the campus.

Firm

Indigenous Design Studio + Architecture

Owner

Navajo Technical University

Location

Chinle, AZ

Start & End Date

February 2016- September 2016

Construction Cost

N/A

Size

38 acres

Owner Contact

Dr. Elmer Guy, President Navajo Technical University
505.786.4327



"Community & Business Training, Economic Development, Partnerships,
Job Creation.....Rural American Indian Communities Moving Forward"



Operated by Southwest Business Development Consultants, LLC Funded by MBDA-U.S. Department of Commerce

Navajo Technical University, Chinle Campus Classroom Building

Navajo Technical University (NTU) has an inspiring vision for their new 38-acre Chinle Campus where it will provide a state-of-the-art, sustainable, learning environment that is deeply rooted in Dine values. Since completing the Campus Master Plan, Indigenous Design Studio + Architecture (IDS+A) is working through Construction Administration towards the fulfillment of NTU's vision for the new Classroom Building for the Chinle Campus.

As phase one of the campus development, the new facility will provide much needed Classroom spaces, Tutoring Space, Staff Support, Library, entry courtyard and site infrastructure that will support future development. The two-story structure will also provide an elevated view of the surrounding landscape before branching off to the laboratory teaching spaces and additional classrooms. In order to make students, staff, and visitors feel connected

to Navajo culture and traditions, the design of the Classroom Building was inspired by ideas of emergence, the surrounding desert landscape, Canyon de Chelly, and traditional Navajo building forms. The new facility uses innovating approaches to energy performance and design with a high-performance building skin and an expressive south facing building façade that will become the defining feature of the new campus.

Another innovative approach is the incorporation of Radon Resistant construction which is in response to the high Radon gas levels in Chinle. As the enrollment grows, providing infrastructure and connections for the future is vitally important to follow the carefully thought out masterplan.

Firm

Indigenous Design Studio + Architecture

Owner

Navajo Technical University

Location

Chinle, AZ

Start & End Date

April 2015 - June 2020

Construction Cost

\$14,000,000.00

Size

20,000 SF

Owner Contact

Dr. Elmer Guy, President
Navajo Technical University
505.786.4327



"Community & Business Training, Economic Development, Partnerships,
Job Creation.....Rural American Indian Communities Moving Forward"



Operated by Southwest Business Development Consultants, LLC Funded by MBDA-U.S. Department of Commerce

Monument Valley Port of Entry Master Development Plan

IDS+A was selected to complete a Master Development Plan for the existing twenty (20) acres Navajo Nation Welcome Center tract in Gouldings, Utah. This existing site is used to welcome travelers and guests to the renowned Monument Valley, where one can experience one of the most majestic views and most photographed points on earth.

Monument Valley brings many visitors from all parts of the world to view and experience the natural erosion of the valley that took place over hundreds of millions of years ago. Today you see the beautiful rock formations, mesas, and buttes that embrace the existing landscape.

IDS+A completed the comprehensive master plan, connecting the existing artisan village with new site facilities and amenities as part of an overall phasing plan.

The new "Navajo Port of Entry" welcomes visitors to discover the history of this region. The site plan co-locates new participatory facilities such as a tour bus drop-off/plaza, rest area/ playground/ overlook, dance amphitheater, arts and crafts demonstration area, service facility, trip center, wastewater treatment center, food court and interactive walking trail with the existing welcoming center to create an active living cultural experience.

Firm

Indigenous Design Studio + Architecture

Owner

Navajo Parks & Recreation Department

Location

Gouldings, UT

End Date

April 2013

Construction Cost

N/A

Size

20 acres

Owner Contact

Martin Begaye, Director
Navajo Parks & Recreation Department
928.871.6647

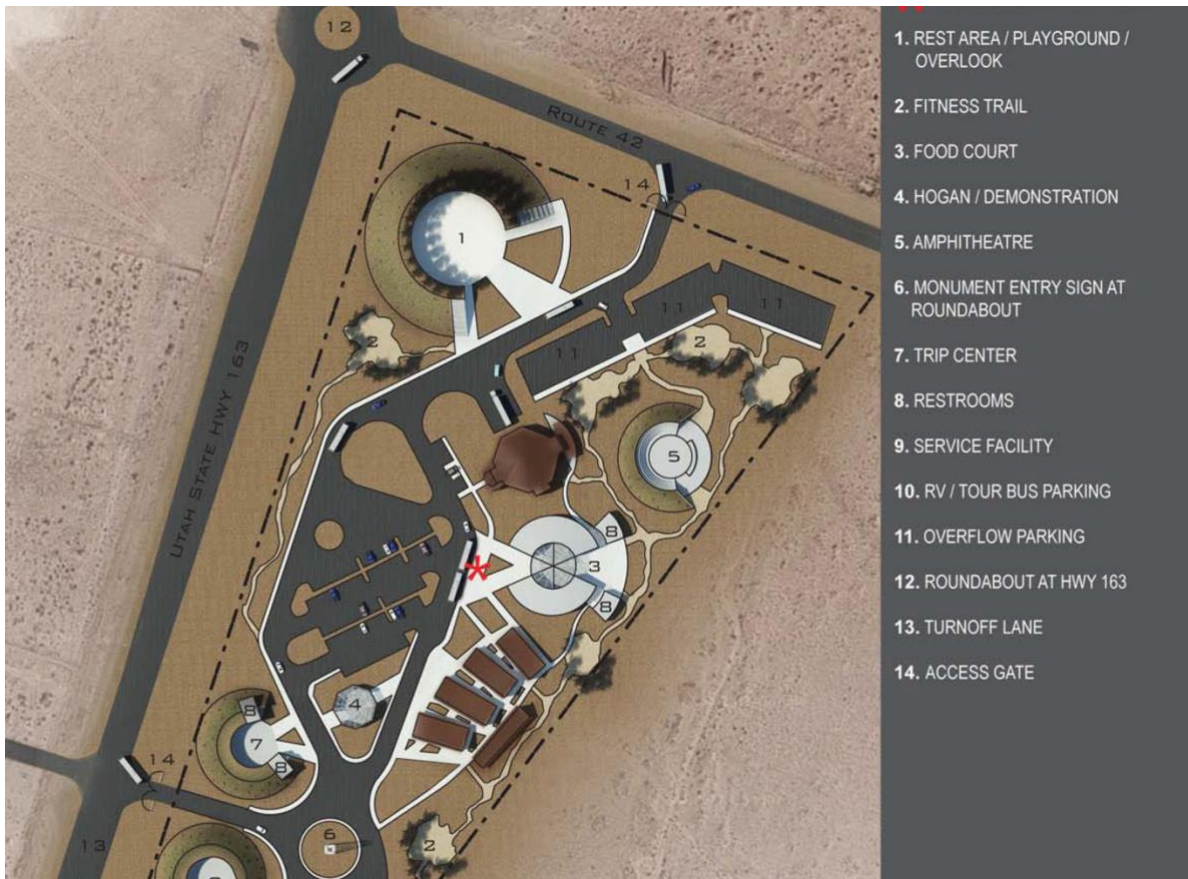



Operated by Southwest Business Development Consultants, LLC Funded by MBDA-U.S. Department of Commerce

Lake Powell Visitor Center Renovation

The Lake Powell Visitor Center Renovation, the existing pre-engineered metal building system, 6,000 sq./ft. building function will change from a feed/general store to a visitor center and office space for park staff. The building will be divided into public and private spaces, construction to include metal stud walls and gypsum wall board, taped, textured and painted finishes.

The ceiling spaces in the public areas will be exposed to the structure, the private spaces will be suspended acoustical tile system and gypsum board ceilings. The public side of the building will consist of a welcome area with reception desk, movable displays, restrooms for the public, a small area to view display videos (open theater), a lounge/internet cafe and food vending area.

Building support rooms to consider in the public area are storage and janitor's closet. All areas are to be ADA accessible and to follow local codes. A security system will be provided for additional safety. The private side will be fully accessible to staff, the areas to be considered are enclosed offices, a couple of workstations for staff, open work area, copy room, lockable storage room, IT/Server Room and a break room for 6-8 staff members.

Other general spaces to include mechanical and electrical rooms for proposed new systems. Windows are to be added to front elevation along with a vestibule for weather protection at the building entry.

Firm

Indigenous Design Studio + Architecture

Owner

Navajo Park and Recreation

Location

Page, AZ

End Date

Summer 2019

Construction Cost

\$1,100,000

Size

6000 SF

Owner Contact

Effie Yazzie, Project Manager
Navajo Parks and Recreation
928.871.6645

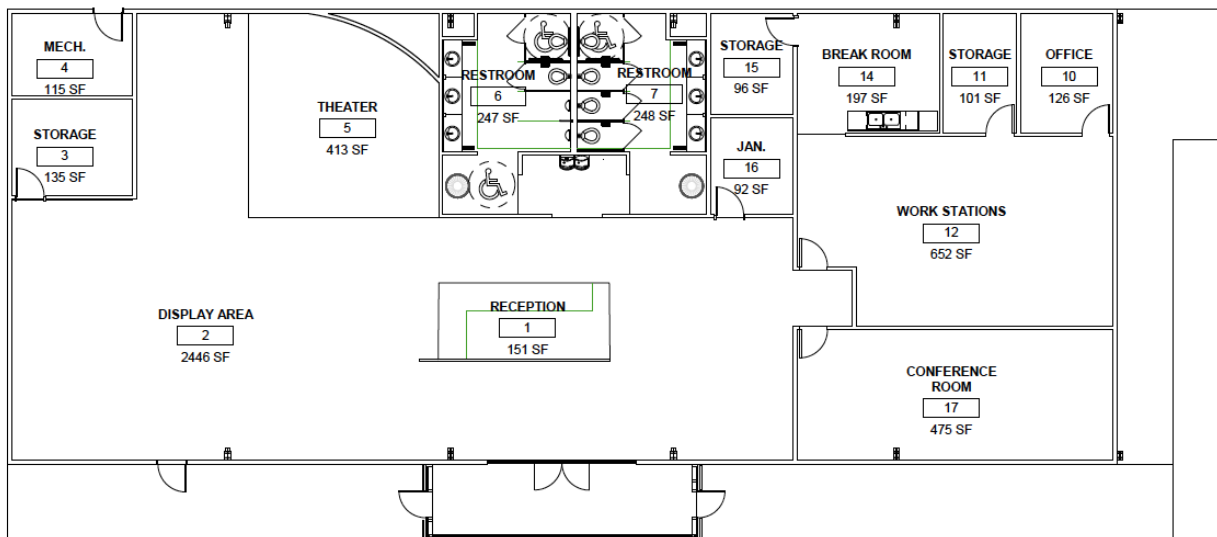

*"Community & Business Training, Economic Development, Partnerships,
Job Creation.....Rural American Indian Communities Moving Forward"*



Operated by Southwest Business Development Consultants, LLC Funded by MBDA-U.S. Department of Commerce

Four Winds Diversified (FWD) teaming partner Mr. Russell F. Pedro of Data Management of New Mexico has been working with Ms. Tamarah Begay, President and Founder of Indigenous Design Studio + Architecture (IDS+A) for over the past year with the Four Winds Diversified (FWD) Project MBDA Business Center assisting their team in executing and pursuing the Small Business Administration 8(a) Certification and Women Owned Program Certification Programs.

Our team is also currently working with IDS+A in seeking strategies to pursue projects within the SBA 8(a) arena in Southwest and across the Nation. As part of our FWD Training Webinar Initiatives, we plan to invite Ms. Begay to share her successes within the Federal, Tribal and State Contracting Arena, as well as, invite her to share her experiences in the pursuit SBA 8(a) Certification Program. We understand that she possesses many years of experience and knowledge in Architectural, Design, Planning and Training that will be invaluable to our FWD Clientele who are seeking diversification within the different and various Federal Contracting Programs. Our FWD team will also assist IDS+A by providing Ms. Begay and her team with Federal, State, Local and Tribal opportunities and referrals.